

TrekPod Owner's Manual



Repeat as desired

Table of Contents

First Steps	1
Taking the TrekPod for a Spin.....	2
Hiking Mode.....	3
Monopod Mode.....	3
Tripod Mode	4
MagMount	4
Specifications:	6
Limited Lifetime Warranty.....	6
Product Repair & Exchange Information	7
Exploded View & Parts List	8

WARNING: Do Not Hike With Legs in the Open Position

TrekPod™ & MagMount™—the trekking tripod system

Congratulations! You are now the proud new owner of the TrekPod™, the revolutionary trekking tripod system that is the most exciting and innovative new product to come along in years for the outdoor sporting world. We know you will find its multi-function use a wonderful addition to your outdoor experience.

The Trek-Tech team is here to support you if needed. Contact us, and learn more about our products, by visiting our website, www.trek-tech.com. You can also visit our web site to find your nearest TrekPod dealer.

First Steps

You should have received with your purchase:

- One TrekPod (see Photo 1)
- One MagMount™ System (MagMount, silver & black Mag Adapters, integrated safety clip, (see Photo 2)
- One cork Palm Rest (see photo 3)

The Mag Adapters connect to your optical devices (camera, binoculars, spotting scope, etc.) using their standard ¼-20 threaded connection points. You can then magnetically quick-connect to the MagMount. The silver Mag Adapter is for lighter weight devices such as smaller digital cameras. The black Mag Adapter is for medium to heavier weight devices. The safety clip secures the upper part of the Mag Adapter to the upper part of the MagMount providing additional security for your optical devices. See the MagMount chapter for more information.



Photo 1



Photo 2

The Mag Adapters are also slotted to aid in tightening and loosening. The light weight adapter has one slot (a “minus”), and the heavy weight adapter has two slots (a “plus”). A nickel, quarter or similarly sized coin can be used for this purpose.

The cork Palm Rest (see Photo 3) attaches magnetically to the MagMount and acts as a comfort rest while walking, hiking, resting or climbing.



Photo 3

Note: for updated information on new and available accessories, or to visit our web store, please visit www.trek-tech.com.

Warranty Information. It is very important to activate your warranty, please take a few moments to register on our website at www.trek-tech.com/warranty, or by mailing the enclosed registration card. (See warranty on page 6 for more information.)

By registering, you will not only initiate your limited lifetime warranty, but you will have the opportunity to become a member of our TrekPod community of users. Here you can post pictures of your adventures with the TrekPod, see where and how other people are using the TrekPod around the world, earn points to win free TrekPod accessories, and tell us if you would like to be kept updated on new products as they become available.

Taking the TrekPod for a Spin

You can use your TrekPod in three different modes:

- Hiking
- Tripod
- Monopod

Hiking Mode

The TrekPod comes completely assembled and ready for use; just adjust the height of the stick to your liking. The general rule of thumb is to set the height so your arm, when holding the cork grip, is bent at 90 degrees. To adjust height, loosen or tighten the locking nut by holding the lower tube with one hand and turning the locking nut with the other hand (see photo 4).

In hiking staff mode, the TrekPod can telescope up to 62.5” (159 cm). At this height you will notice a marking on the upper tube that says “stop here”. This is the TrekPod’s maximum height.

Before hiking, make sure the TrekPod legs are tightly together. Turn the TrekPod upside down, put your hand close to the Velcro and squeeze the legs together (see Photo 5), and then wrap the Velcro tightly around the legs. Squeezing the legs creates a nice tight leg closure and eliminates any leg noise when using the TrekPod as a hiking staff or monopod.



Photo 4



Photo 5

WARNING: Do Not Hike With Legs in the Open Position

Monopod Mode

The only difference between Monopod and Hiking mode is the use of the palm rest. By taking off the palm rest you now have two device mounting options. You can connect

any optical device to the top of the **MagMount** by attaching one of the Mag Adapters (see Photo 2) to the bottom of your optical device. You can also remove the **MagMount** from the **TrekPod** and have a standard ¼ 20 threaded stud available enabling you to directly screw on your optical device.

Tripod Mode

Change the **TrekPod** from hiking or monopod mode to tripod mode by unhooking the Velcro strap and extending the legs to their most open position (see Photo 6). Set the height as noted above. The **TrekPod**'s friction-stop leg hinge allows for the use of the **TrekPod** on somewhat uneven terrain



Photo 6



Photo 7

(see Photo 7) by adjusting the legs to compensate for the contour of the ground.

You can adjust the leg tension (to your taste and to compensate for wear over time) by adjusting the Allen head screw at the hinge joint between the legs. Do not over tighten (see Photo 8).



Photo 8

A 5/32" (4mm) Allen head wrench is required (not included) to make this adjustment. When going back to hiking staff mode, follow the instructions in the "Hiking mode" section to make sure the legs are tightly secured together.

MagMount

You and your MagMount—getting connected

See Photo 2 to review the components of the **MagMount** System. The **MagMount** can be used either with your **TrekPod** or with any other tripod or monopod. **Note:** a few

monopods have short ¼-20 threaded studs so the **MagMount** may not mount securely.

Screw the appropriate Mag Adapter onto your optical device (silver for small digital cameras or black for heavier cameras, spotting scopes, or binoculars). Set your optical device on the **MagMount** (see Photo 9). If your optical device is not weight balanced over the **MagMount**, line up the heavy side of the device over one of the legs for additional stability.



Photo 9

Loosen the ball head locking knob on the **MagMount** for re-positioning. There is a cutout in the **MagMount** housing to allow your camera to rotate to portrait positioning as well. Re-tighten the knob when your device is positioned as you want it. You should note how tightly held your optical device is to the **MagMount**. (If you use a heavy optical device, it will come off of the **MagMount** a bit easier than when you are using a lighter device.)

The safety clip is housed on the lower section of the **MagMount**. (see Photo 10) Pull it off the housing and slide it onto the Mag Adapter and Magnet Holder (see Photos 11 & 12). The safety clip will secure your optical device to the **MagMount** whenever needed.



Photo 10

Note: Even in direct physical contact, the magnet will cause no harm to digital or film media.

There is an article published in the August 2004 PC World magazine



Photo 12



Photo 11

titled, “Busting the Biggest PC Myths”, explaining how magnetic devices do not damage digital forms of data storage.

The article can be read at: <http://www.pcworld.com/news/article/0,aid,116572,00.asp>.



Photo 13

The magnet is a powerful rare earth magnet that can pinch fingers, and could possibly, in close proximity, cause damage to the electronics in a pacemaker. **Please handle with care!**

If you place a Mag Adapter on the MagMount without a device attached, you will find it very difficult to remove. If this happens, we suggest you attach a device to the Mag Adapter (see photo 13) and use a tilting or lever motion to separate it from the MagMount. Best practice is to store Mag Adapters on their respective devices to guard against loss, and for the highest level of convenience.

Caution: The magnet, in very close contact, can affect magnetic media, such as the magnetic strip on the back of your credit cards, or the magnetic recording tape used in cassette recorders and some digital video cameras.

Specifications:

TrekPod weight	29 oz./.82 kg (including MagMount)
MagMount weight	3 oz./.085 kg (as separate accessory)
Height range in tripod mode	43 to 60 inches/109 to 152 cm
Height range in Hiking Staff/monopod mode	46.5 to 62.5 inches/118 to 159 cm
Disassembled, packable length	Two components, approximately 35.5 inches/90cm or less
Open leg diameter	22 inches/56 cm

Limited Lifetime Warranty

Your TrekPod and MagMount are warranted for as long as you own them. We warrant them to be free of defects in materials and workmanship, and to function satisfactorily under normal, intended-use conditions.

If at any time a warranted product is found to have a defect in materials or workmanship, Trek-Tech will, at our discretion, repair or replace it free of charge, when requested by the original owner, or a properly registered subsequent owner.

The warranty is void if damage results from unauthorized repair, alteration, or misuse. Note that walking or hiking with the tripod legs open is misuse. Further, with the legs open, the TrekPod should only be "placed" on the ground, not "forced or jammed" onto (or into) the ground.

The warranty is granted to the original owner and can be transferred to subsequent owners by following the “Subsequent Owner Registration” process on our website. To activate or transfer the warranty, register the product online at www.trek-tech.com/warranty or complete the enclosed warranty card, stamp and mail as addressed.

This is a limited warranty, and you may have other rights which vary from state to state. The obligation of the warrantor is solely to repair or replace the product. The warrantor is not liable for any incidental or consequential damage due to such defect.

Product Repair & Exchange Information

If your TrekPod or MagMount should ever require repair or refurbishment, in or out of warranty, you need to request a Return Authorization so that when it arrives we’ll be able to act as quickly as possible to get it back to you.

To process a warranty claim, please request a Return Authorization and instructions by filling out the RA form at www.trek-tech.com/warranty, or call us at 503-459-0030.

You will also find a complete selection of replacement and spare parts in our web store.

REMEMBER: Do Not Hike With Legs in the Open Position!

Exploded View & Parts List

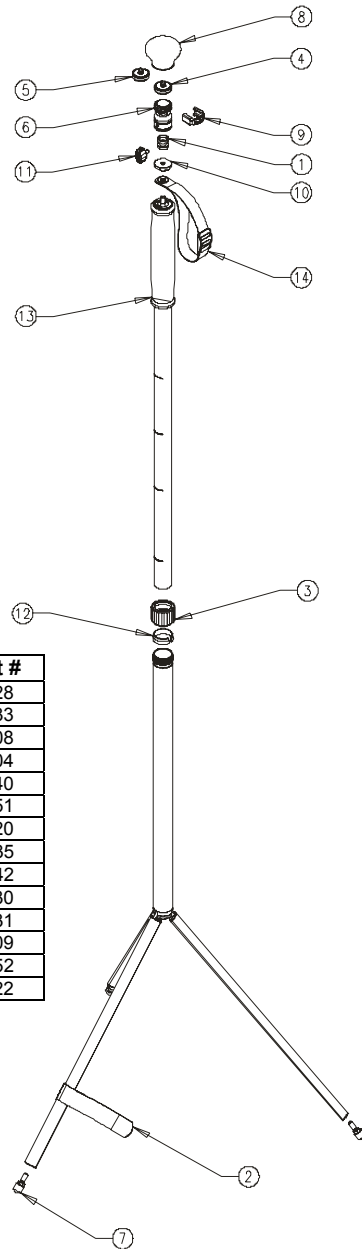

Item	Qty	Name/Description	Part #
1	1	Ball Swivel Socket	00028
2	1	Leg Strap	00033
3	1	Locking Nut	00008
4	1	Mag Adapter – Heavy Force (black)	00004
5	1	Mag Adapter – Light Force (silver)	00040
6	1	MagMount Replacement	00051
7	3	Overmolded Foot Assembly	00020
8	1	Cork Palm Rest Assembly	00035
9	1	Safety Clip Assembly	00042
10	1	Strap Retainer	00030
11	1	Swivel Lock Knob Assembly	00031
12	1	Tapered Ring	00009
13	1	Upper Tube Assembly	00052
14	1	Wrist Strap Assembly	00022

